

# Synthetic VA Flowmeters

## KM-335 KM-350

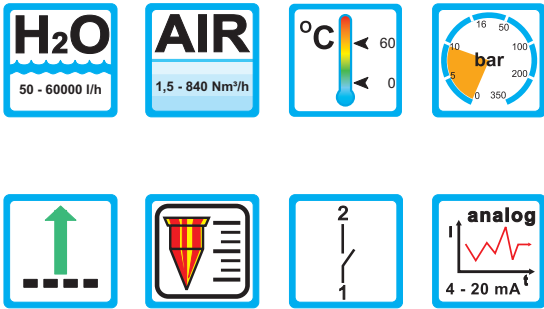

### Range of Application

#### Operation

- Float measuring principle

#### Application

- Cooling systems and cooling circuits
- Mechanical engineering and construction
- Pharmaceutical industry
- Chemical industry
- Research and development

#### Features

- Shatterproof and corrosion resistant
- Easily removable from the pipe system
- Mounting for accessories (limit switches)
- Adhesive special scales, for liquid and gaseous media
- DN (rated width), measuring range, and material specified on the measuring tube

#### Installation information

- Download: [www.meister-flow.com](http://www.meister-flow.com)

### Operating Data

Operating pressure max.:	PN 10 at 20 °C
Pressure drop:	see table on page 4
Accuracy:	see table on page 5

#### Operating temperature:

measuring tube	process connection	max. temp at 1 bar	
PVC-U	PVC-U	0 °C	to +60 °C
PA	PVC-U	0 °C	to +60 °C
PSU	PVC-U	0 °C	to +60 °C

### Measuring Ranges

Type	Measuring range for H <sub>2</sub> O at 20 °C	
	[l/h]	[gpm]
KM-3..-500	50 - 500	0,22 - 2,2
KM-3..-1000	100 - 1000	0,44 - 4,4
KM-3..-1500	150 - 1500	0,66 - 6,6
KM-3..-2500	250 - 2500	1,1 - 11
KM-3..-2000	200 - 2000	0,88 - 8,8
KM-3..-3000	300 - 3000	1,32 - 13,2
KM-3..-6000	600 - 6000	2,64 - 26,4
KM-3..-6000	600 - 6000	2,64 - 26,4
KM-3..-10000	1000 - 10000	4,4 - 44,02
KM-3..-15000	1500 - 15000	6,6 - 66,04
KM-3..-20000	2000 - 20000	8,8 - 88
KM-3..-30000	3000 - 30000	13,2 - 132
KM-3..-60000	8000 - 60000	35,2 - 264



# Technical Data

## Mechanical drawing

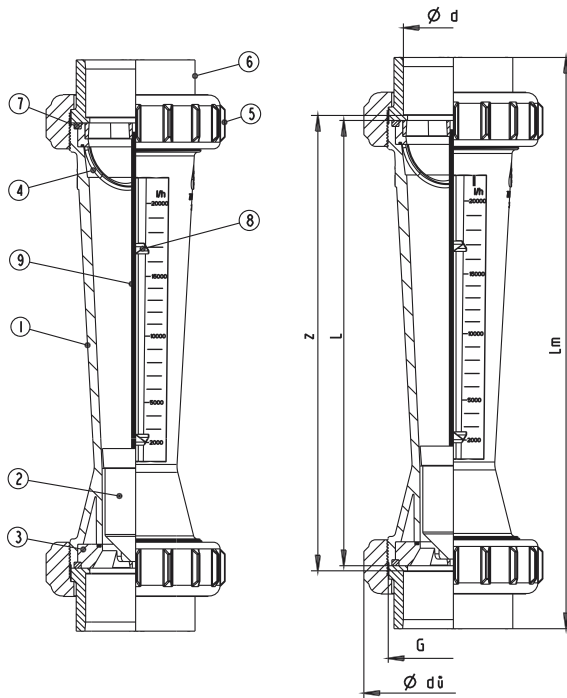

process connection with solvent cement socket PVC or weld socket PP

## Process connection

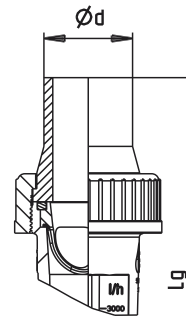

process connection with weld socket (butt end) PP

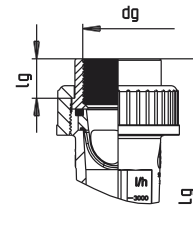

process connection with threaded socket PVC, PP annealed cast iron or stainless steel.

## Materials

Item	Description	Nr. of pieces	Material
1	Measuring tube	1	PVC, PA, PSU
2	Float	1	PVDF
3	Insert bottom	1	PVDF
4	Insert top	1	PVDF
5	Coupling ring	2	PVC (standard), PP

Item	Description	Nr. of pieces	Material
6	Connector	2	PVC (standard), PP
7	O-Ring	2	EPDM (standard), FPM
8	Limit value indicator	2	PS
9	Guide rail <sup>(1)</sup>	1	PVDF / stainless steel

<sup>(1)</sup> DN 50 and larger (1500 - 15000 l/h)



# Dimensions and weights

## Dimensions and weights KM-335

Overall dimensions [mm]

Measuring range H <sub>2</sub> O [l/h]						solvent cement socket PVC			weld socket PP			PP-Socket (butt end)			threaded socket			Weight [kg]
	DN	d	G	d <sub>ü</sub>	L	d <sub>m</sub>	z	L <sub>m</sub>	d <sub>m</sub>	z	L <sub>m</sub>	d	L <sub>g</sub>	S SDR 11	d <sub>g</sub>	L <sub>g</sub>	l <sub>g</sub>	
50 - 500	25	32	1 1/2"	60	335	32	341	385	32	345	381	32	455	2,9	1"	385	17	0,52
100 - 1000																		
150 - 1500	32	40	2"	72	335	40	341	393	40	345	385	40	461	3,7	1 1/4"	393	19	0,60
250 - 2500																		
200 - 2000	40	50	2 1/4"	83	335	50	341	403	50	345	391	50	467	4,6	1 1/2"	403	23	1,22
300 - 3000																		
600 - 6000	50	63	2 3/4"	103	335	63	341	417	63	345	399	63	473	5,8	2"	417	23	1,68
600 - 6000																		
1000 - 10000	65	75	3 1/2"	122	335	75	341	429	75	345	407	75	587	6,9	2 1/2"	-	-	2,90
1500 - 15000																		
2000 - 20000	65	75	3 1/2"	122	335	75	341	429	75	345	407	75	587	6,9	2 1/2"	-	-	2,90
3000 - 30000																		
8000 - 60000																		

## Dimensions and weights KM-350

Overall dimensions [mm]

Measuring range H <sub>2</sub> O [l/h]						solvent cement socket PVC			weld socket PP			PP-Socket (butt end)			threaded socket			Weight [kg]
	DN	d	G	d <sub>ü</sub>	L	d <sub>m</sub>	z	L <sub>m</sub>	d <sub>m</sub>	z	L <sub>m</sub>	d	L <sub>g</sub>	S SDR 11	d <sub>g</sub>	L <sub>g</sub>	l <sub>g</sub>	
50 - 500	25	32	1 1/2"	60	350	32	356	400	32	360	396	32	460	2,9	1"	400	17	0,52
100 - 1000																		
150 - 1500	32	40	2"	72	350	40	356	408	40	360	400	40	476	3,7	1 1/4"	408	19	0,60
250 - 2500																		
200 - 2000	40	50	2 1/4"	83	350	50	356	418	50	360	406	50	482	4,6	1 1/2"	418	23	1,22
300 - 3000																		
600 - 6000	50	63	2 3/4"	103	350	63	356	432	63	360	414	63	488	5,8	2"	432	23	1,68
600 - 6000																		
1000 - 10000	65	75	3 1/2"	122	350	75	356	444	75	360	422	75	602	6,9	2 1/2"	444	-	2,90
1500 - 15000																		
2000 - 20000	65	75	3 1/2"	122	350	75	356	444	75	360	422	75	602	6,9	2 1/2"	444	-	2,90
3000 - 30000																		
8000 - 60000																		

KM-335 - 350 3 0002 10-13 E M



# Technical Data

## Combinations

Measuring tube	Float	Insert top and bottom	O-Ring
PVC	PVDF	PVDF	EPDM (optional FPM)
PA	PVDF	PVDF	EPDM (optional FPM)
PSU	PVDF	PVDF	EPDM (optional FPM)

## Connection options

Socket	Socket (butt end)	Plastic inside thread	Metal inside thread
PVC solvent cement socket (standard)	PP weld socket (butt end)	PVC	stainless steel V4A
PP weld socket		PP	annealed cast iron

## Pressure drop

Measuring range [l/h]	50 - 500	100 - 1000	150 - 1500	250 - 2500
Pressure drop [mbar]	22,84	22,84	22,84	22,84
Measuring range [l/h]	200 - 2000	300 - 3000	600 - 6000	
Pressure drop [mbar]	24,99	24,99	24,99	
Measuring range [l/h]	1000 - 10000	1500 - 15000		
Pressure drop [mbar]	24,99	28,23		
Measuring range [l/h]	2000 - 20000	3000 - 30000	6000 - 60000	
Pressure drop [mbar]	45,67	45,67	47,24	

## Pressure - temperature - diagram

The curves in the diagram represent values for the durability of three different materials in relation to the operating temperature.

Pressure-temperature diagram for float-type flowmeters

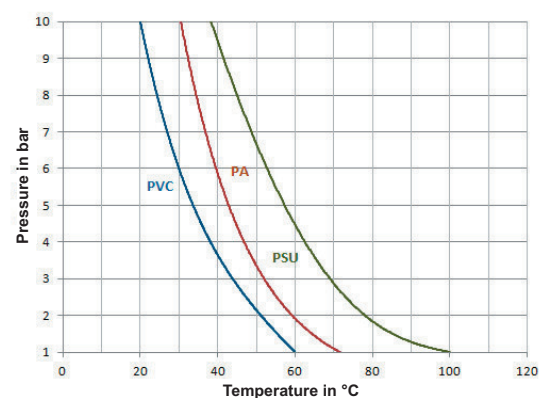

KIM-335 - 350 4 0002 10-13 E M



## Accuracy and special scales

### Accuracy

Accuracy class 4, VDE/VDI 3513, sheet 2

Flow in %	10	20	30	40	50	60	70	80	90	100
Total error of measurement in %	13,00	8,00	6,33	5,50	5,00	4,67	4,43	4,25	4,11	4,00
Total error of full scale in %	1,3	1,6	1,9	2,2	2,5	2,9	3,1	3,4	3,7	4,0

### Special scales

Measuring range H <sub>2</sub> O [l/h]	HCl 30 - 33% [l/h]	NaOH 30% [l/h]	NaOH 50% [l/h]
50 - 500	20 - 405	4 - 226	1 - 55
100 - 1000	55 - 866	15 - 600	3 - 192
150 - 1500	90 - 1340	30 - 970	6 - 365
250 - 2500	165 - 2310	70 - 1800	15 - 770
200 - 2000	115 - 1660	35 - 1240	8 - 520
300 - 3000	190 - 3050	75 - 2370	15 - 1170
600 - 6000	420 - 4900	230 - 4000	50 - 2270
600 - 6000	430 - 5090	240 - 4700	55 - 2300
1000 - 10000	750 - 9460	475 - 7340	140 - 4340
1500 - 15000	1415 - 11570	1030 - 10330	420 - 5820
2000 - 20000	1500 - 17300	915 - 11720	245 - 7590
3000 - 30000	2175 - 24120	1195 - 16040	400 - 11120
8000 - 60000	5000 - 58000	300 - 34000	1700 - 13000



## Special scales

### Special scales

Measuring range H <sub>2</sub> O [l/h]	Air 0 bar [Nm <sup>3</sup> /h]	Air 1 bar [Nm <sup>3</sup> /h]	Air 2 bar [Nm <sup>3</sup> /h]	Air 3 bar [Nm <sup>3</sup> /h]	Air 4 bar [Nm <sup>3</sup> /h]
50 - 500	1,5 - 14	3 - 20	3 - 24	3 - 28	4 - 31
100 - 1000	2,5 - 29	4 - 41	5 - 50	5 - 58	6 - 65
150 - 1500	4 - 45	6 - 63	7 - 77	8 - 90	9 - 100
250 - 2500	7 - 79	10 - 111	12 - 136	14 - 158	16 - 177
200 - 2000	6 - 58	9 - 82	11 - 100	12 - 116	14 - 130
300 - 3000	9 - 108	13 - 152	16 - 186	18 - 216	21 - 241
600 - 6000	17 - 174	24 - 246	30 - 301	34 - 348	39 - 389
600 - 6000	17 - 175	24 - 247	30 - 302	34 - 350	39 - 392
1000 - 10000	29 - 301	41 - 425	51 - 520	58 - 602	65 - 674
1500 - 15000	53 - 405	75 - 572	92 - 700	106 - 810	119 - 907
2000 - 20000	55 - 545	78 - 770	96 - 942	110 - 1090	124 - 1200
3000 - 30000	80 - 758	113 - 1072	139 - 1311	160 - 1516	180 - 1697
8000 - 60000	140 - 840	200 - 1150	250 - 1450	300 - 1650	300 - 1850

Measuring range H <sub>2</sub> O [l/h]	Air 5 bar [Nm <sup>3</sup> /h]	Air 6 bar [Nm <sup>3</sup> /h]	Air 7 bar [Nm <sup>3</sup> /h]	Air 8 bar [Nm <sup>3</sup> /h]
50 - 500	4 - 34	5 - 37	5 - 39	4,5 - 42
100 - 1000	7 - 71	7 - 76	8 - 82	7,5 - 87
150 - 1500	10 - 110	11 - 119	12 - 127	12 - 135
250 - 2500	18 - 193	19 - 209	20 - 223	21 - 237
200 - 2000	15 - 142	16 - 153	17 - 164	18 - 174
300 - 3000	23 - 264	24 - 286	26 - 305	27 - 324
600 - 6000	42 - 426	45 - 461	49 - 492	51 - 522
600 - 6000	42 - 428	45 - 463	49 - 495	51 - 525
1000 - 10000	72 - 737	77 - 797	83 - 851	87 - 903
1500 - 15000	130 - 992	141 - 1073	150 - 1146	159 - 1215
2000 - 20000	135 - 1335	146 - 1444	156 - 1542	165 - 1635
3000 - 30000	197 - 1857	212 - 2008	227 - 2145	240 - 2274
8000 - 60000	350 - 2000	350 - 2200	400 - 2300	400 - 2500



# Limit switch contact ZNC and ZNO

## Application

The limit switch contacts are used to monitor flow limits. They are slid onto the guide located on the flowmeter and can be set to any value of the corresponding scale.

## Operation

A built-in magnet in the float closes or opens a reed contact encapsulated in the switch housing. The switching function is bistable, that is, the switching state is maintained, even when the magnetic float is away from the contact.



## Switching state

		Float [above]	Float [below]
ZNC	(Normally closed) / Min	open	closed
ZNO	(Normally open) / Max	closed	open

## Technical data

Switching voltage <sup>(1)</sup>	max. 230 V~
Switching capacity <sup>(1)</sup>	max. 10 W / 12 VA
Switching current <sup>(1)</sup>	max. 0,5 A
Contact resistance	< 200 mOhm
Insulation resistance	> 10 <sup>11</sup> Ohm
Permissible ambient temp.	0 to + 55 °C
Protection type (IP)	IP65 (DIN 40050)
Switch-on / -off hysteresis	1 - 2 mm float

<sup>(1)</sup> Exceeding these values, even temporarily, is not allowed.



# Analog transmitter ZAT-300

## Description

The analog transmitter provides an output signal of 4 - 20 mA corresponding to the vertical position of the magnetic float in the flow meter.

### Please note:

Since the resolution of the various scales are different, the transmitters are factory set to the respective measuring range. Therefore, when ordering, always specify the required measuring range.

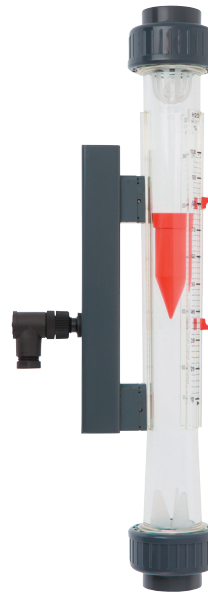

## Electrical connection

PIN 1:	Operating voltage	12 - 24 V
PIN 2:	Output signal	4 - 20 mA
PIN 3:		0 V

## Technical data

Supply voltage	12 - 24 VDC (+/- 10 %)
Power consumption	< 50 mA
Load resistance	max. 500 Ohm
Current output	4 - 20 mA (3-wire)
Protection type (IP)	IP 65
Ambient temp.	0 to + 50 °C
Connection	Connector DIN 43650
Accuracy	< 1 %

## Functional elements

- A: Flow meter KM-335 / 350 with magnetic float
- B: Analog transmitter ZAT-300
- C: Connector
- D: Guide rail
- E: Fixing screws

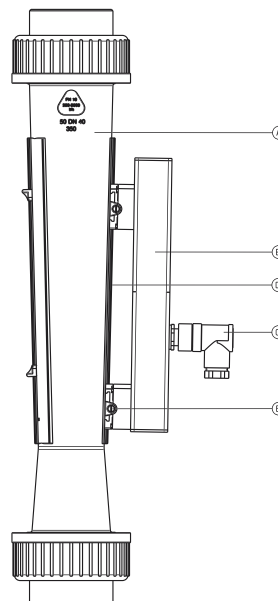
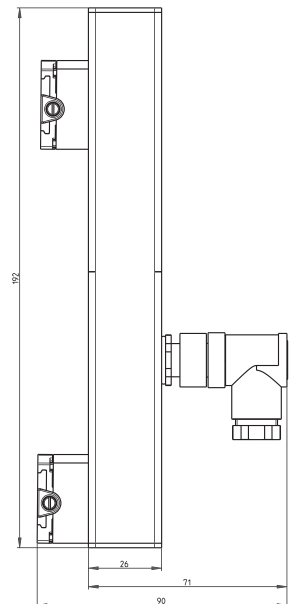

KM-335 - 350 8 0002 10-13 E M